

A

TYPICAL PERIMETER DETAIL

NOTES:

1. SETTING BLOCK (SILL ONLY)
ALTERNATES BY OTHERS:
A. HARDWOOD
B. CALCIUM SILICATE
C. NEOPRENE (90 DURO)
2. CONTINUOUS INTUMESCENT TAPE
FURNISHED W/VDS FRAME
INSTALLED BY OTHERS
3. *GLAZING GASKET (BOTH SIDES)
FURNISHED W/VDS FRAME
INSTALLED BY OTHERS
4. FIRE RATED SEAL
ALTERNATES BY OTHERS:
A. WELL PACKED ROCKWOOL
B. CONTINUOUS INTUMESCENT CAULKING
C. CONTINUOUS INTUMESCENT TAPE
5. SHIMS
ALTERNATES BY OTHERS:
A. HARDWOOD
B. CALCIUM SILICATE
C. CEDAR SHIM SHINGLES
6. FINISH SEALANT BY OTHERS
7. ANCHOR SCREWS BY OTHERS, 20" O.C.

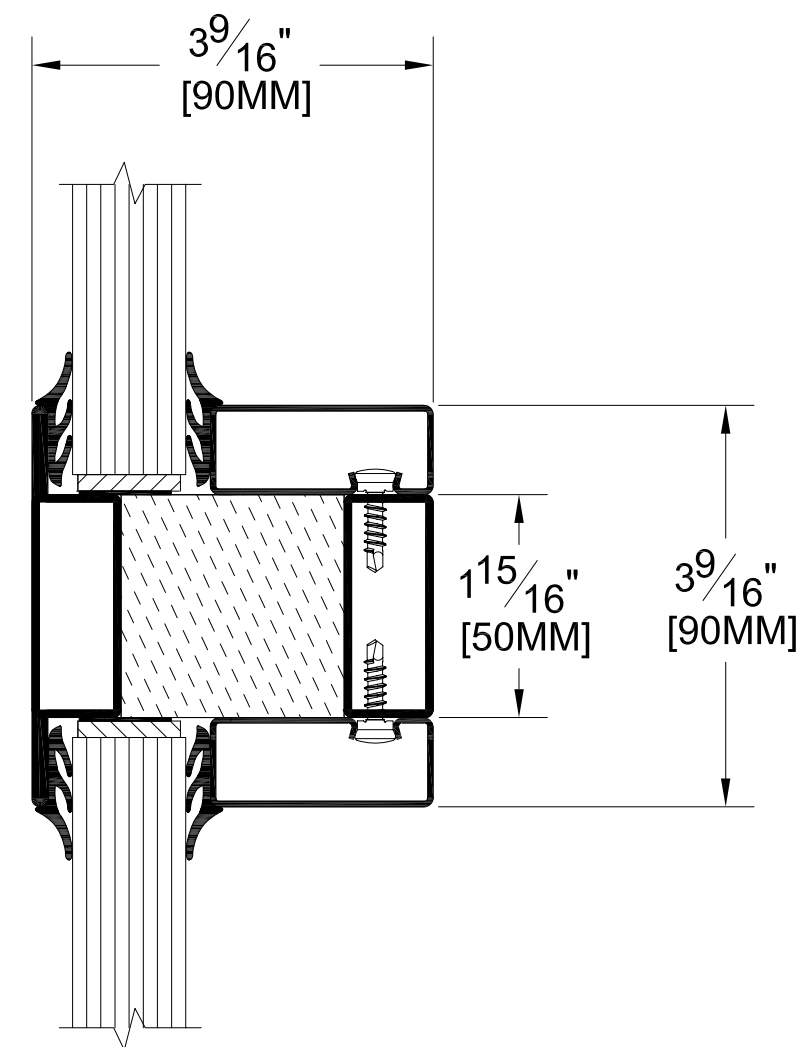

B

TYPICAL MULLION

***NOTE: DUE TO GLASS TOLERANCE, SEALANT MAY BE NEEDED TO HOLD ON VINYL GLAZING GASKET (PROVIDED AND INSTALLED BY OTHERS)**



TITLE
VDS 60
INTERIOR

PROJECT
VDS 60 STANDARD FLUSH GLAZED

JOB NO.				REV.	DATE	SHEET No.
-				-	-	
DRAWN BY	DATE	CHECKED BY	DATE			1 of 1
R. Marlow	-	-	-			