

SGG SWISSFLAM[®] STRUCTURE 6o

Fire Resistant Safety Glass

SGG SWISSFLAM STRUCTURE 6o for interior application

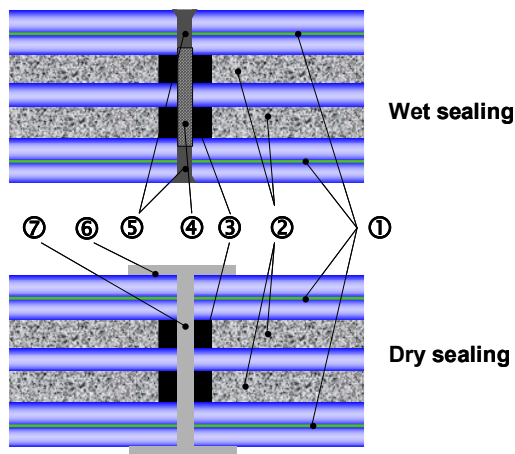

- 1: Laminated safety glass
- 2: Float glass
- 3: Intumescent interlayer
- 4: Sealing polysulphide
- 5: Kerafix Blähpapier +3: 2 pcs 2x8mm
- 6: Sealing
- 7: Glue
- 8: Silicone profile
- I Ground edge
- II Arris edge

Technical Data

Fire resistance classification	EI 60
Element thickness	32 mm
Minimum production size	250 x 350mm
Maximum production size	1950 x 3150mm
Max. tested size	Varying subject to make-up, frame system, element type and national approval certificates. For details please contact our sales office.
Width tolerance	+2 / -1 mm
Length tolerance	+1.5 / -1.5 mm
Weight	≥ 65kg / m ²
Light transmission (EN 410)	81 %
Sound reduction r _w (EN 140-3)	44 dB
UG value (EN 673)	4.0 W/m ² K
UV stable	As per EN ISO 12543-4 Pt.6
Temperature range	+45°C / -10°C