

# SGG CONTRAFLAM<sup>®</sup> STRUCTURE LITE 30

*Fire Resistant Safety Glass*

Data Sheet

## SGG CONTRAFLAM Structure Lite 30 for interior application

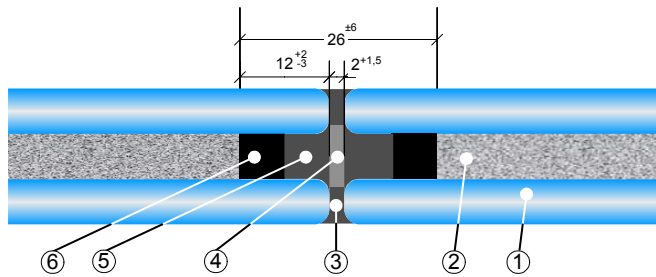

- 1:  $\leq 1500 \times 3000$  6mm TSG  
 $\geq 1500 \times 3000$  8mm TSG
- 2: Intumescent interlayer
- 3: Sealing: only released silicone acc. to glazing instruction
- 4: Intumescent material acc. to glazing instruction
- 5: Sealing polysulphide
- 6: Spacer TPS

## Technical Data

Fire resistance classification	E / EW 30
Element thickness	$\geq 18$ mm (nominal thickness for smallest pane sizes)
Minimum production size	190 x 350 mm
Maximum production size	1800 x 3210 mm (oversizes upon request)
Max. tested size	Varying subject to make-up, frame system, element type and national approval certificates. For details please contact our sales office.
Width tolerance	+2/ -1 mm
Length tolerance	+2/ -2 mm
Width of edge compound	13 +2/-3 mm
Width of joint and edge compound of two glasses	$26 \pm 6$ mm (for installation acc. to glazing instruction)
Edge work	Smoothly ground edge acc. to EN 12150-1
Weight	39 kg / m <sup>2</sup> (*)
Light transmission (EN 410)	84 % (*)
Sound reduction $r_w$ (EN 140-3)	38 dB (*)
UG value (EN 673)	4,8 W/m <sup>2</sup> K (*)
UV stable	Acc. to EN ISO 12543-4 Pt.6
Temperature range	+45°C / -10°C

(\*)= values valid for nominal thickness of 18 mm

# SGG CONTRAFLAM<sup>®</sup> STRUCTURE 30

*Fire Resistant Safety Glass*

*Data Sheet*

## SGG CONTRAFLAM Structure 30 for interior application

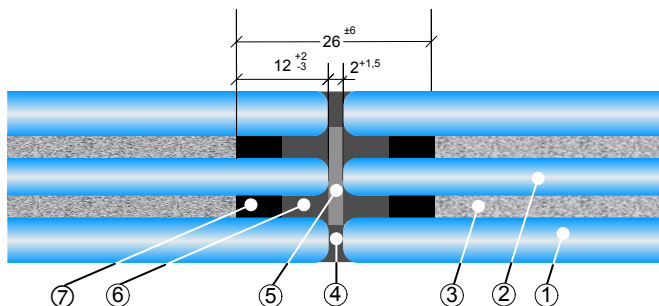

- 1: ≤ 1500x3000 6mm TSG  
≥ 1500x3000 8mm TSG
- 2: ≤ 1500x3000 5mm TSG  
≤ 1800x3210 6mm TSG
- 3: Intumescent interlayer
- 4: Sealing: only released silicone acc. to glazing instruction
- 5: Intumescent material acc. to glazing instruction
- 6: Sealing polysulphide
- 7: Spacer TPS

## Technical Data

Fire resistance classification	EI 30
Element thickness	≥ 23 mm (nominal thickness for smallest pane sizes)
Minimum production size	190 x 350 mm
Maximum production size	1800 x 3210 mm (oversizes upon request)
Max. tested size	Varying subject to make-up, frame system, element type and national approval certificates. For details please contact our sales office.
Width tolerance	+2/ -1 mm
Length tolerance	+2/ -2 mm
Width of edge compound	13 +2/-3 mm
Width of joint and edge compound of two glasses	26 ± 6 mm (for installation acc. to glazing instruction)
Edge work (1)	Smoothly ground edge acc. to EN 12150-1
Weight	52 kg / m <sup>2</sup> (*)
Light transmission (EN 410)	81 % (*)
Sound reduction $r_w$ (EN 140-3)	38 dB (*)
UG value (EN 673)	4.7 W/m <sup>2</sup> K (*)
UV stable	Acc. to EN ISO 12543-4 Pt.6
Temperature range	+45°C / -10°C

(\*)= values valid for nominal thickness of 23 mm

# SGG CONTRAFLAM<sup>®</sup> STRUCTURE 60

*Fire Resistant Safety Glass*

## SGG CONTRAFLAM Structure 60 for interior application

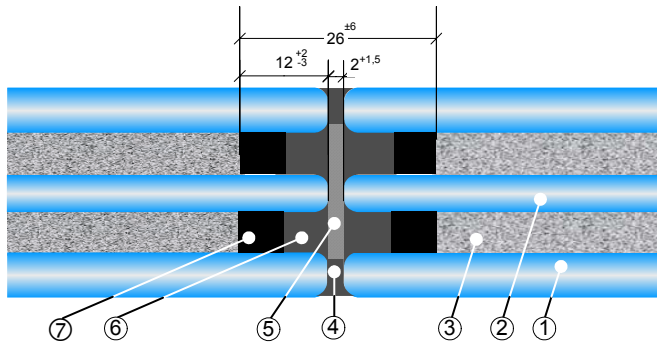

- 1: ≤ 1500x3000 6mm TSG  
≥ 1500x3000 8mm TSG
- 2: ≤ 1500x3000 5mm TSG  
≤ 1800x3210 6mm TSG
- 3: Intumescent interlayer
- 4: Sealing: only released silicone acc. to glazing instruction
- 5: Intumescent material acc. to glazing instruction
- 6: Sealing polysulphide
- 7: Spacer TPS

## Technical Data

Fire resistance classification	EI 60
Element thickness	≥ 28 mm (nominal thickness for smallest pane sizes)
Minimum production size	190 x 350 mm
Maximum production size	1800 x 3210 mm (oversizes upon request)
Max. tested size	Varying subject to make-up, frame system, element type and national approval certificates. For details please contact our sales office.
Width tolerance	+3/ -2 mm
Length tolerance	+2/ -2 mm
Width of edge compound	13 +2/-3 mm
Width of joint and edge compound of two glasses	26 ± 6 mm (for installation acc. to glazing instruction)
Edge work (1)	Smoothly ground edge acc. to EN 12150-1
Weight	59 kg / m <sup>2</sup> (*)
Light transmission (EN 410)	80 % (*)
Sound reduction r <sub>w</sub> (EN 140-3)	41 dB (*)
UG value (EN 673)	4.2 W/m <sup>2</sup> K (*)
UV stable	Acc. to EN ISO 12543-4 Pt.6
Temperature range	+45°C / -10°C

(\*)= values valid for nominal thickness of 28 mm